

CONTENTS

	Page
1. HANDLING ATTENTION	2
2. SET UP · OPERATION	3
3. MACHINE PARTS	4
4. ATTACHMENTS PARTS	5
5. MAINTENANCE DOOR INSIDE	6
6. CONTROL PANEL BASE BOX	7~8
7. MONITOR ADJUSTMENT	9
8. GAME BOARD CHANGE	10
9. CONTROL PANEL CHANGE	11
10. MONITOR CHANGE	12~14
11. HOW TO MAKE MMP CONTENTS	15
12. PARTS LIST	16~29
13. DIAGRAM	30

Please pay enough attention when set up or inspect this machine as follows.
Any mishandling might cause accident or trouble of this machine.



- Please handle it after shutting off power. If not, it might cause electric shock or trouble of machine.
- Do not take off plug hastily. It might cause electric shock or trouble.
- Do not touch plug while hand is wet. It might cause electric shock or trouble.
- Do not expose power cord or ground wire on pathway.
- Do not put anything above power cord or damage it. It might cause fire or electric shock.
- Do not pull power cord strongly when set up. Any damage to it might cause fire or electric shock.
- Ground wire must be set. If not, it might cause electric shock.
- Use specified fuse. If using others, it might cause fire or electric shock.
- Power is from AC95~AC110V. The best condition is to use AC100V.
- Do not revise this machine, it might cause unexpected trouble.
- In case of any emergency, please shut down power, stop operation and pull the power code from plug. Otherwise it might cause fire or other accidents.

Warranty

This machine has 3 months' warranty after selling. We will repair it in case of trouble caused initially by us. When in trouble, please pull power code from plug and contact our office as soon as possible.

The other trouble caused by nature, inevitable accidents will be out of warranty.

RS Co.,Ltd.

TEL 092-622-1337 FAX 092-622-1348

2. SET UP · OPERATION ATTENTION



- This machine is used indoors. Please do not set it outdoors.
- Indoors, please do not set in the following places.
 - Place where rain or water leaks, near to pool, shower.
 - Place where gets sunshine directly, or near to stove, heater.
 - Place with flammable gas, volatile drugs or other dangerous stuff.
 - Place wherever has much dust.
 - Place with strong vibration.
 - Exit, near to fire extinguisher, and other emergency supplies.
 - Place which is under 5°C or over 30°C.
- Please use single power with circuit breaker. Without the breaker, it might Cause fire when circuit short
- Do not use multi-wiring. Too much burden might cause heat and fire.
- Make enough space more than W0.9mD1.6m.
- Make sure door must be over W0.9mH1.6m.



- Please confirm adjusters reach to floor. If it is not firmly reached to floor, The cabinet might move during play.
- Do not place any heavy things on this machine. It might cause accident or Damage to machine parts.
- Do not climb to the machine.
- Confirm that door, cover parts are not damaged.
- Do not put vessel with water, drug above or around the machine.
- Do not let the following personnel play on this game. It might cause unexpected accident or injury.
 - Person who must need help at walking, with high pressure, heart disease
 - Who has lost consciousness during playing TV game.
 - Person who has disease at neck, spinal and who is pregnant.
 - Person who is easily drunk and who is drunken.
 - Please stop behavior such as kicking or hitting this machine.

3. MACHINE PARTS

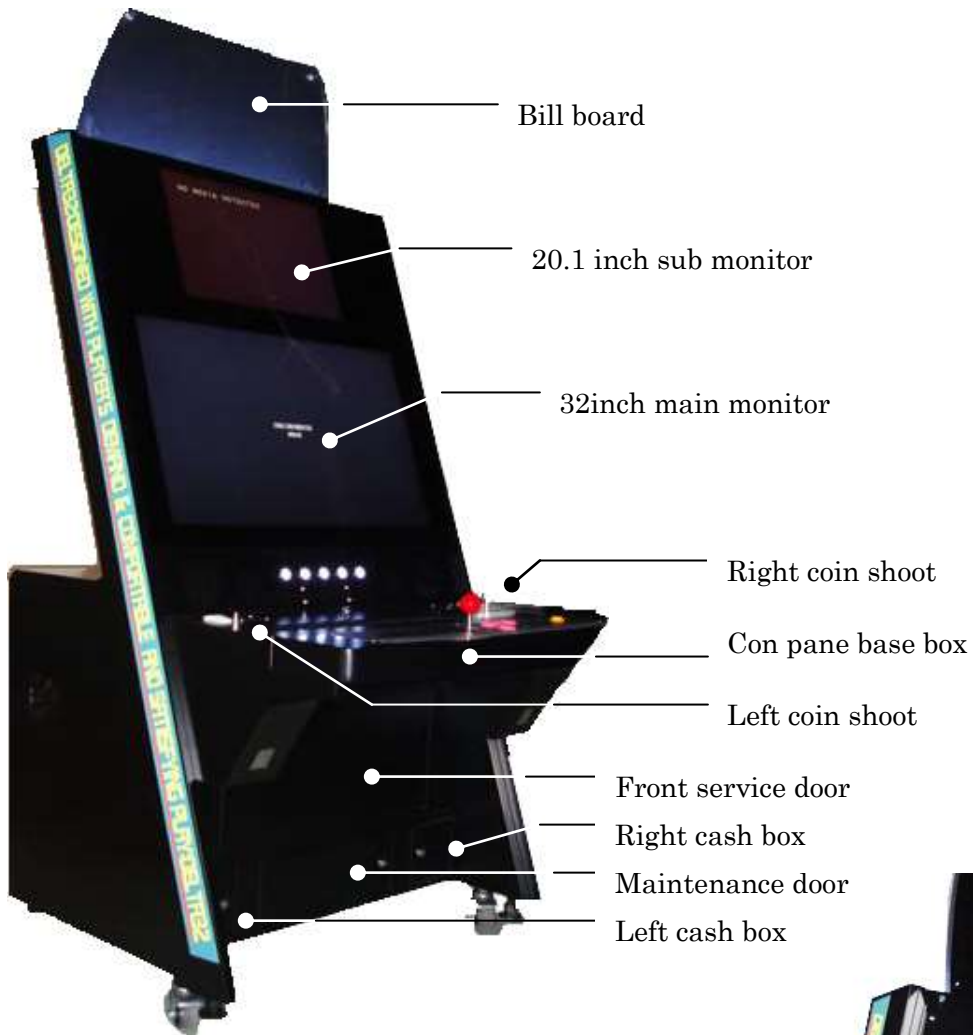

SIZE	
Cabinet	875(W)×900(D)×1,530(H)
Full set	875(W)×900(D)×1,780(H)



※ Please refer to serial number attached to this machine in case of inquiry to us.

Rear service door

AC UNIT



4. ATTACHEMENT PARTS



MMP remote controller



CF card



CF card reader



Key 001 × 2pcs



Key 002 × 2pcs



50Yen entry plate



Entry seal 50 円

Entry seal 100 円

Entry seal 100 円 2PLAY

Entry seal MEDAL

5. MAINTENANCE DOOR INSIDE



- Test SW :
- Service SW1 : Coin meter will not count.
- Service SW2 : SW for 2PLAYER
- CP : Circuit protector

It will cut circuit when over-burdened power runs to PCB.

- Power SW :
- Meter1 : Count coins at right side coin shooter.
- Meter2 : Count coins at left side coin shooter.
- Meter3 : In case of necessity.
- Meter4 : In case of necessity.
- 5V LED : Red LED Lamp, turn on when power is on.
- 3.3V LED : Green LED Lamp, turn on when power is on.
- 5V modulation : Modulate 5V volume.
- 3.3V modulation: Modulate 3.3V volume.

Attention: Voltage is set up from factory. Please do not change.

- Bass・Treble : Modulate speaker volume.
- Left・right stereo volume : Modulate right, left speaker volume separately.
- Voltage check terminal :Check voltage of 5V and 3.3V.

6. CONTROL PANEL BASE BOX INSIDE

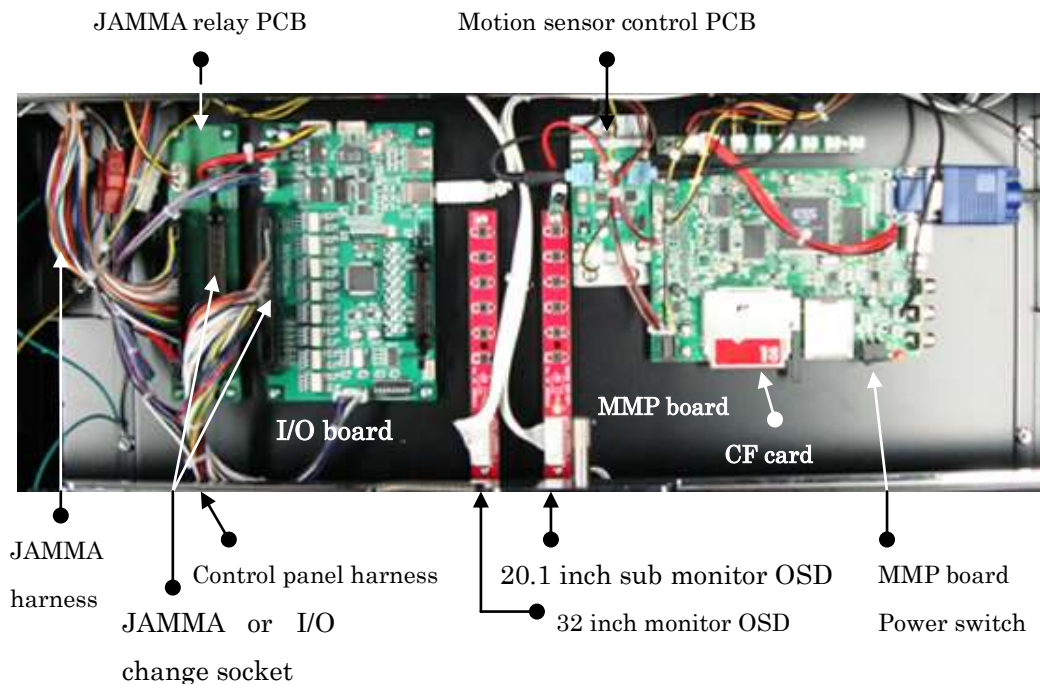

- I/O board
Control In-Out signal (test, service, coin switch, meter, control panel) except picture and sound.
- Control panel harness
Harness for control panel button, joysticks. Change I/O board or JAMA relay PCB according to PCB played.
- MMP board
Control PCB for 20.1 inch sub monitor's picture contents.
Input still pictures, movies from computer to CF card.
Attention: Shut down main power or MMP board power when insert CF card Or take out. It might damage the data in CF card while power is on.
- Motion sensor control PCB
Control sound from MMP contents by sensing human begins. Sound time can be Controlled by volume. Turn it right, sound time will become longer.
- 20.1 inch monitor OSD
Modulate 20.1 inch monitor.
- 32 inch monitor OSD
Modulate 32 inch main monitor.

- N Coin P Credit Control D I P SW
Set up coin and credit at left coin shoot.

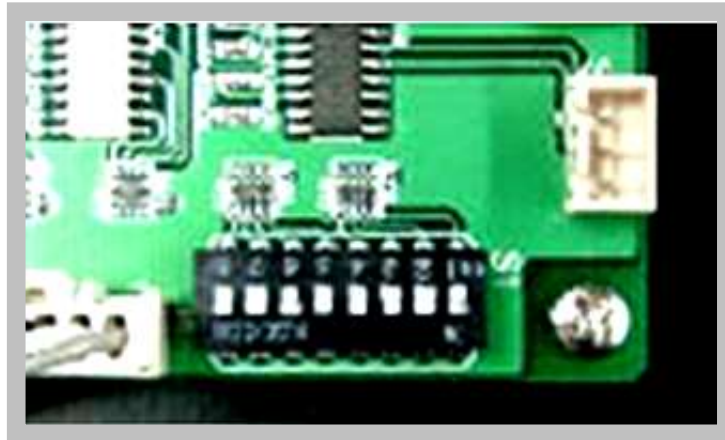

COIN					CREDITS				
	5	6	7	8		1	2	3	4
1 coin	OFF	ON	ON	ON	1 credit	OFF	ON	ON	ON
2	ON	OFF	ON	ON	2	ON	OFF	ON	ON
3	OFF	OFF	ON	ON	3	OFF	OFF	ON	ON
4	ON	ON	OFF	ON	4	ON	ON	OFF	ON
5	OFF	ON	OFF	ON	5	OFF	ON	OFF	ON
6	ON	OFF	OFF	ON	6	ON	OFF	OFF	ON
7	OFF	OFF	OFF	ON	7	OFF	OFF	OFF	ON
8	ON	ON	ON	OFF	8	ON	ON	ON	OFF
9	OFF	ON	ON	OFF	9	OFF	ON	ON	OFF
10	ON	OFF	ON	OFF	10	ON	OFF	ON	OFF
11	OFF	OFF	ON	OFF	11	OFF	OFF	ON	OFF
12	ON	ON	OFF	OFF	12	ON	ON	OFF	OFF
13	OFF	ON	OFF	OFF	13	OFF	ON	OFF	OFF
14	ON	OFF	OFF	OFF	14	ON	OFF	OFF	OFF
15	OFF	OFF	OFF	OFF	15	OFF	OFF	OFF	OFF

7. Monitor adjustment

Adjust monitor by OSD. Adjusting way for 32 inch and 20.1 inch is the same. Here is a sample in case of adjusting 32 inch monitor.

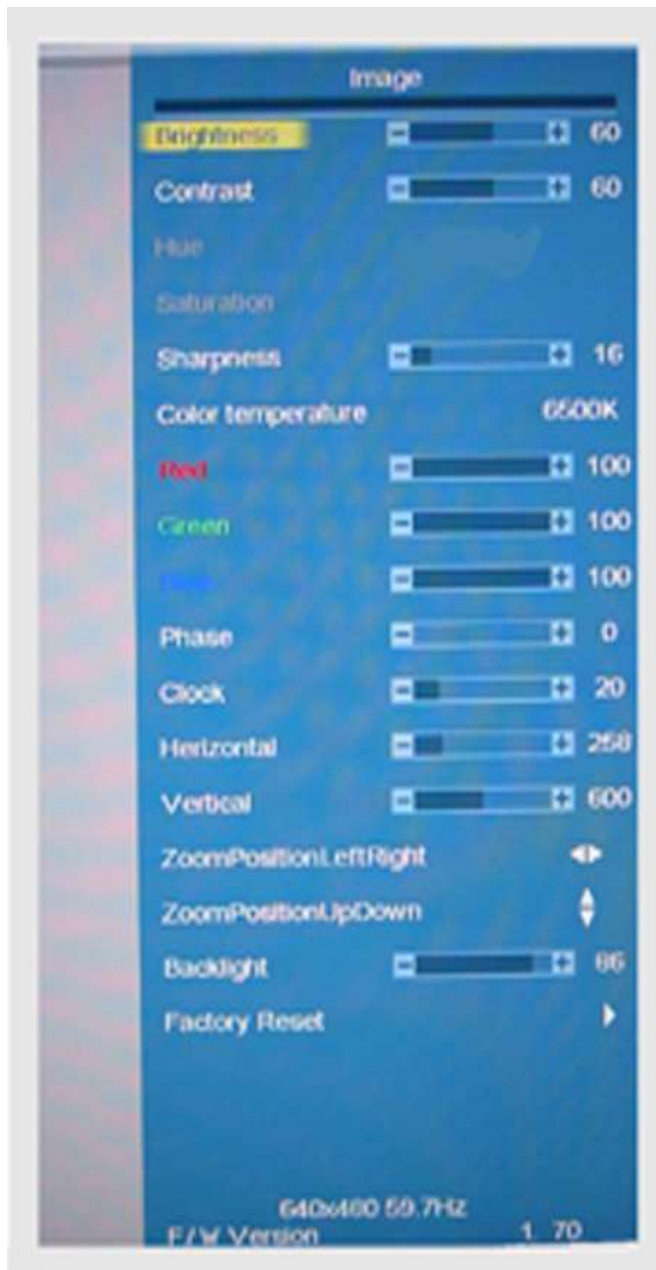

- Use mainly AUTO、MENU、SEL、DOWN、UP.
- AUTO will set automatically.
Push several times if failed once.
- Push MENU, left side OSD menu Opens. Use SEL to choose items Push DOWN、UP to adjust.
- Horizontal.
- Vertical.
- Zoom Position Left Right
- Zoom Position Up Down
- MENU+UP to change to auto color.
- POWER to shut monitor power On、Off.
- LED LAMP
Normally it is green.
If it turns on red, there is no Picture signal when power is on.
If it turns on orange, monitor Power is not on.

8. GAME BOARD CHANGE

Picture : Inside of rear service door

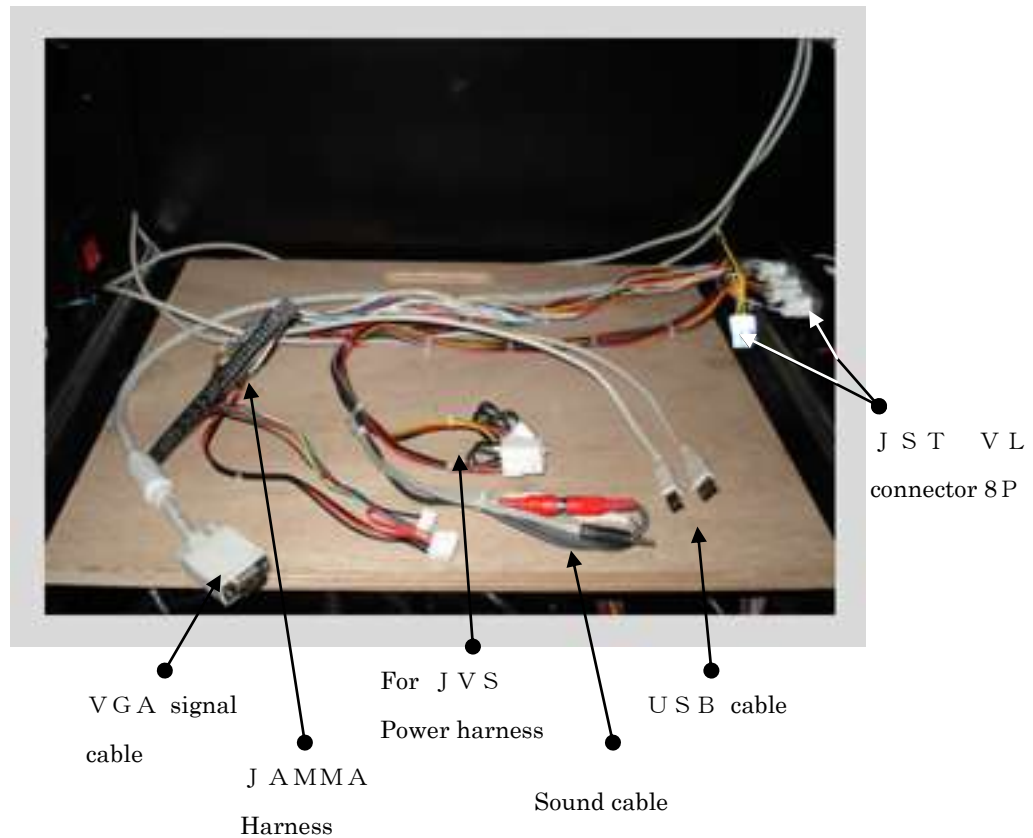

- Please shut down power before touching inside door in order to prevent electric shock.
- Do not make any damage to harness. It will cause electric shock , accident.

Both JAMMA、 or JAMMA VIDEO(JVS) game board can be used on this Cabinet. Please use proper JAMA or JVS power cable according to game board. Please change to use JST VL connector 8P (male) if necessary. Connector No.4、 No.8 with 3.3V harness(brown color) is for JVS.

9. CONTROL PANEL CHANGE



警告

- Please shut down power when doing this operation in order to prevent electric shock.
- Do not make any damage to harness. It will cause electric shock , accident.



注意

- Pay attention to fingers when open or close control panel base.
- Control panel base could fall down automatically, Please make sure The control panel base is firmly opened by any support.

Open control panel base box first, push slide lever to right, the base can be Pulled out.

Control panel is fixed by M4 screws and Nut F 6 .Please tie the cables in order To prevent harness entangled, then remove nut.



10. MONITOR CHANGE



- Please pull out plug of power before setting or removing monitor, monitor connector. It will cause electric shock if power is on.
- Only technician with enough electrical knowledge or experience can do this work. Otherwise it will cause electric shock.
- Please keep enough space for safety. It will cause accident or miss in a small space.
- Do not make any damage to harness. It will cause electric shock , accident.



- At lease 2 persons should cooperate at changing monitor because Of monitor's weight. If only 1 person operates, it might cause falling down of monitor to damage parts or cause accident.



Remove bill board first.
Remove 3 screws at different positions.

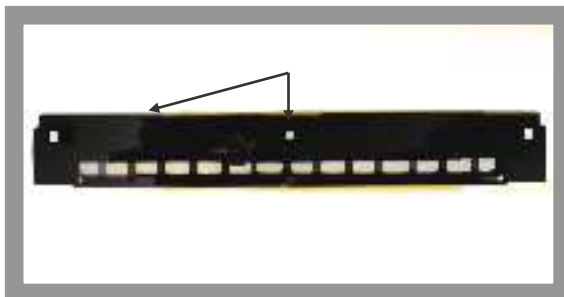

Take off light cover above.
Remove screws at different positions.



Push down monitor glass cove a little,
Then pull it up slowly.



Put the glass cover at a safe position.
Pay attention not to fall down.



Remove monitor back door.
Remove 3 screws ,then slide it up slowly.



Remove all 4 screws which fix the monitor
cover.



Remove monitor cover from outside.
This picture shows what it looks
After cover is removed.



Remove all harness in 3 positions.
Pay attention not to damage harness.



Remove all screws fixed to surface of
Monitor. Take out monitor with monitor
Stay. When one person removes screws,
The other must support the monitor at
The same time because monitor is heavy.
]



Remove monitor stay from it.
Put stay to new monitor and then restore
It.

11. HOW TO MAKE MMP CONTENTS

** Media of contents is compact flash.

** There are 5 kinds of contents.

- 1) Title contents which shows up when power turns on.
- 2) Contents which shows when push the first button.
- 3) Contents which shows when push the second button.
- 4) Contents which shows when push the third button.
- 5) Contents which shows when push the fourth button.

**Contents includes pictures or movies taken by digital camera.

**Graphics are also suitable in case of JPG style.

Please make the graphics at 16:9 in the middle and then transfer it to 4:3.

**When insert CF card reader into socket, folders will show up.

Sample contents are input from factory.

Push 1st button to show A1 folder, 2nd button to show B2 folder.

Push 3rd button to show C3 folder, 4th button to show D4 folder.

Push menu button to show E5 folder, input proper contents in it.

**Input the same contents into E5 folder and outside of E5 folder.

**If there are several contents in one folder, it will show up like slide-show.

Slide show can be re-arranged by Alphabet order, or number order.

HOW TO USE MMP remote controller

Open control panel base box, operate the controller directing to 20.1 inch monitor OSD sensor receiver.



Push Setup button to enter MMP' s SETUP MENU main page.

Push Enter button to enter each menu.

Push Enter button to decide to go up, down, right, or left.



12. PARTS LIST

RY-0320(DELTA-32)

1. Assembly-1

No.	Part No.	Part Name	Description	Q'ty	Remark
1	1100050	Assy Body		1	
2	1100051	Assy PR P late		1	
2-1	6140403	Screw	M 4.0*10.0L	3	
3	1100051	Assy Speaker P late		1	
3-1	2200281	Locker-1		1	
3-2	2200282	Locker-2		1	
3-3	2200283	H nge P late		1	
3-4	6140403	Screw	M 4.0*10.0L	12	
4	2200280	Button P late Case		1	
5	1100051	Assy Button P late		1	
5-1	6140402	Screw	Special M 4.0*10.0L	6	
5-2	8010403	Nut	M 4.0	6	

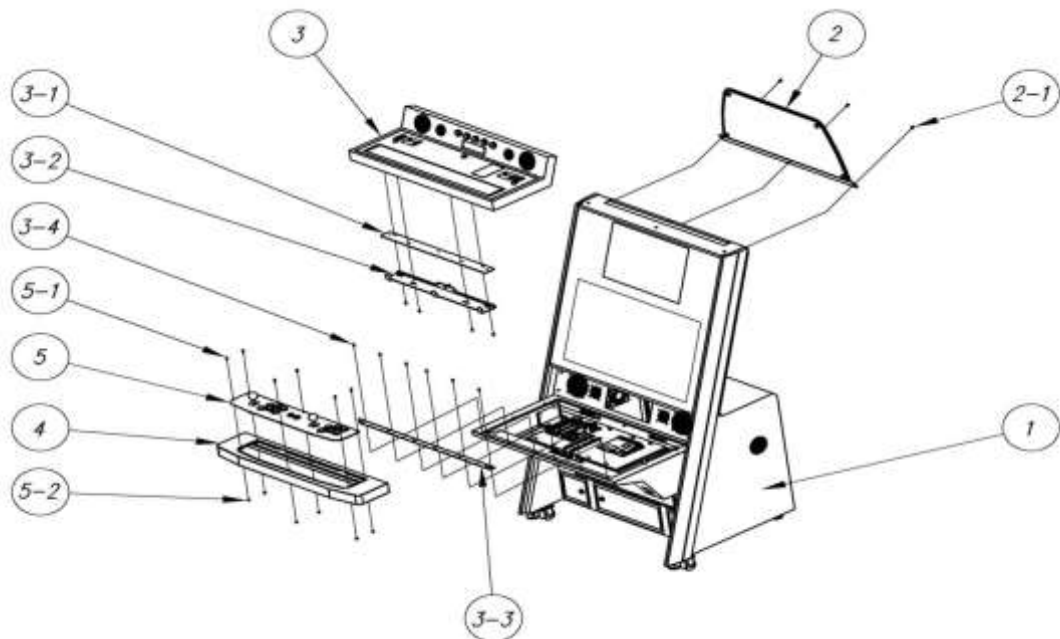

2. Assembly-2

No.	Part No.	Part Name	Description	Q 'ty	Remark
1	1100050	Assy Body		1	
1-1	2200286	Rear Cover		1	
1-2	6140401	Screw	M 4.0*10.0L	3	
1-3	4200111	G lass		1	
6	1100061	Assy Button P late Support		1	
7	1100062	Assy Upper Fram e Cover		1	

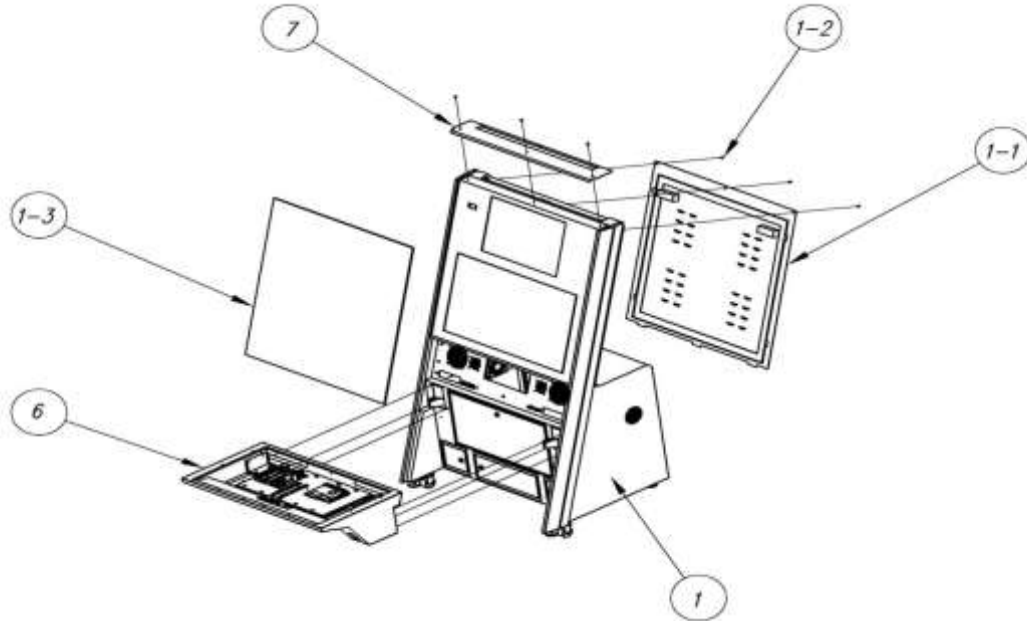

3. Ass'y Body-1

No.	Part No.	Part Name	Description	Q 'ty	Remark
1	1100050	Assy Body		1	
1-4	6140401	Screw	M 4.0*10.0L	4	
1-5	2200208	Mask		1	
1-6	2200203	Lower G lass angle		1	
1-7	6140401	Screw	M 4.0*10.0L	3	
1-8	2200204	Door-Center		1	
1-9	1700021	Ass'y Key		4	
1-10	2200205	Door-Power Case		1	
1-11	2200206	Co h Box-LH		1	
1-12	2200207	Co h Box-RH		1	

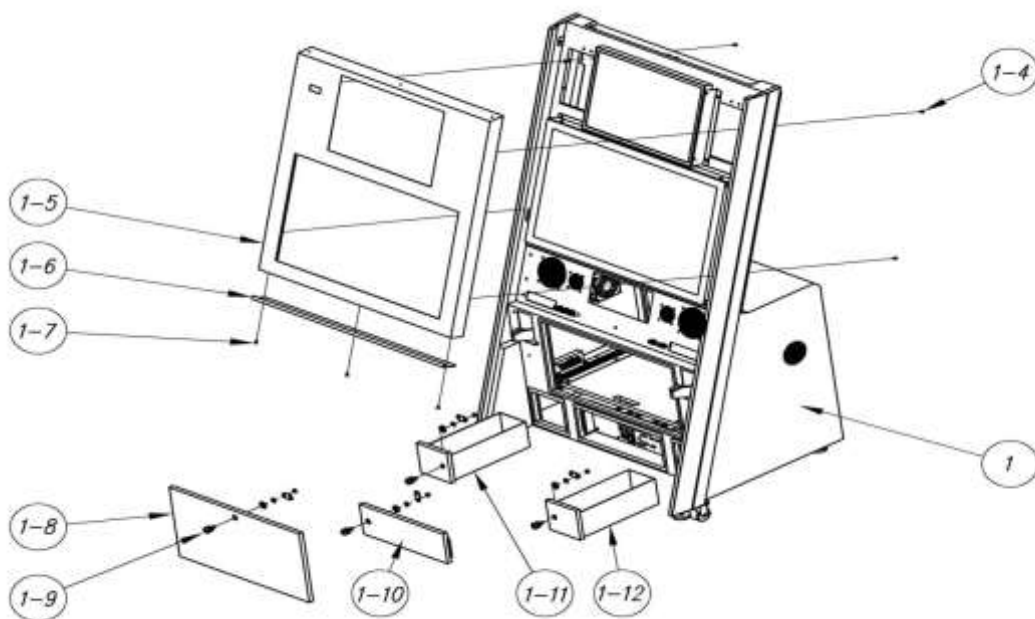

4. Ass'y Body-2

No.	Part No.	Part Name	Description	Q'ty	Remark
8	1100070	Ass'y Power Case		1	
9		Ass'y 20.1" LCD		1	
10		Ass'y 32" LCD		1	
1-13	6140401	Screw	M 4.0*10.0L	4	
1-14	6140401	Screw	M 4.0*10.0L	4	
1-15	6140401	Screw	M 4.0*10.0L	4	
1-16	1700021	Ass'y Key		1	

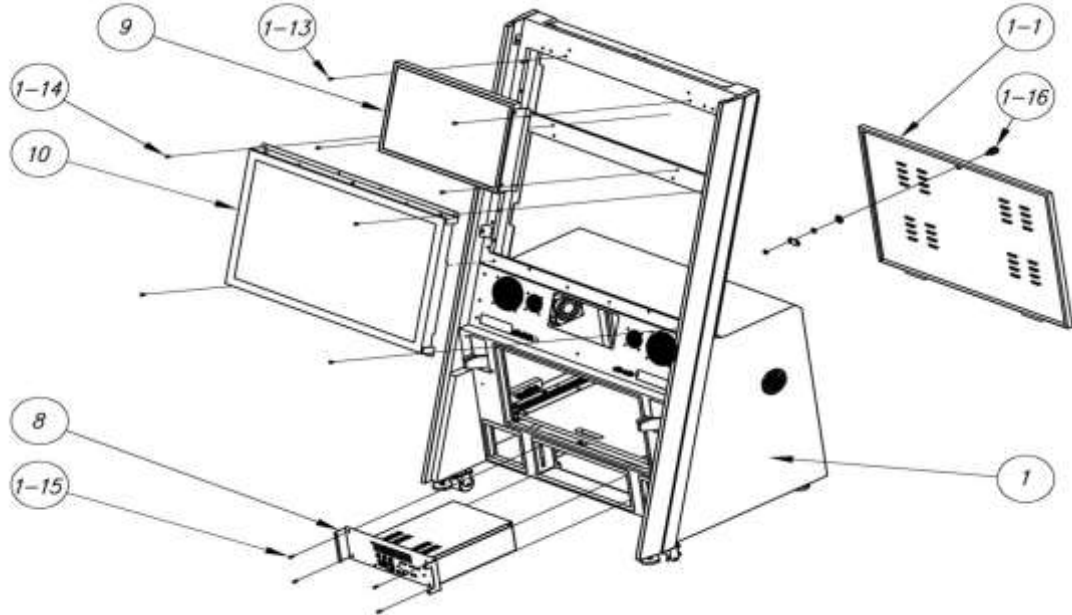

5. Ass'y Body-3

No.	Part No.	Part Name	Description	Q'ty	Remark
1-17		Connector-4P		1	
1-18		Connector-6P		1	
1-19		Connector-8p		1	
1-20		Connector-4P-Sm all		1	
1-21		Connector-10P-Sm all		1	
1-22		Connector-12P-Sm all		1	
1-23	6150323	Screw	3.0 Tapping	6	
1-24	22002093	Wooden P late	Wood	1	
1-26	2200210	Monitor Fram e		1	
1-27	6150501	Screw	M 5.0*10.0L	19	

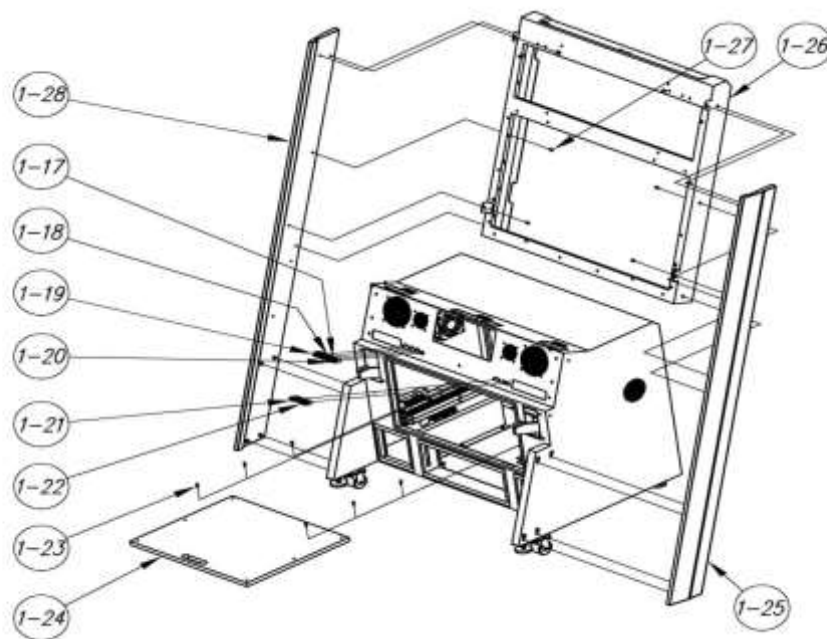

6. Ass'y Body-4

No.	Part No.	Part Name	Description	Q 'ty	Remark
1-25	4900110	Ass'y P illar-RH	AL	1	
1-28	4900111	Ass'y P illar-LH	AL	1	
1-29	6140405	Screw	Spec ial M 4.0	8	

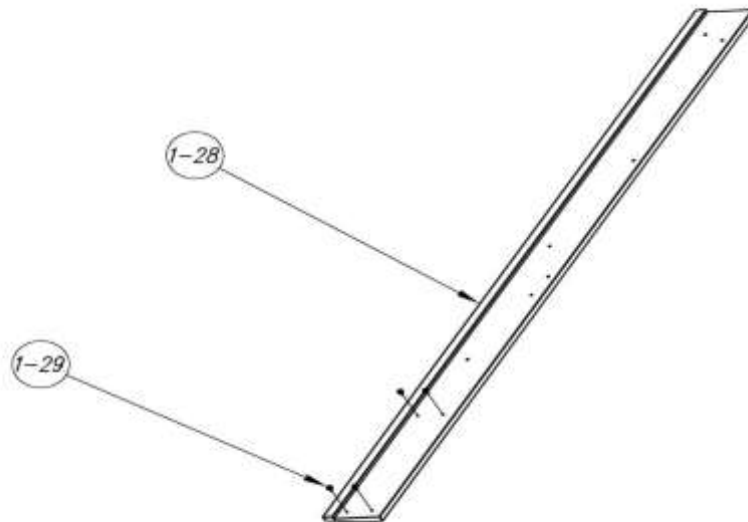
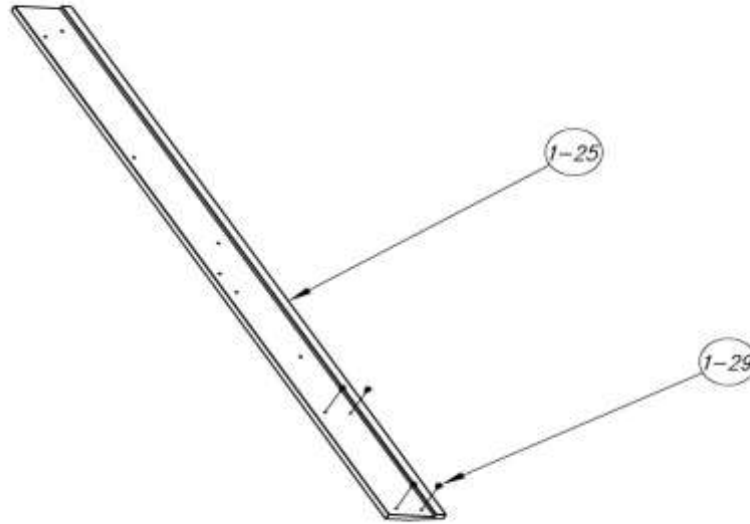

7. Ass'y Body-5

No.	Part No.	Part Name	Description	Q'ty	Remark
1-30	2200211	Meshy-Speaker		2	
1-31		Speaker-1		2	
1-32	8010403	Nut	M 4.0 Plate	8	
1-33		Speaker-2		2	

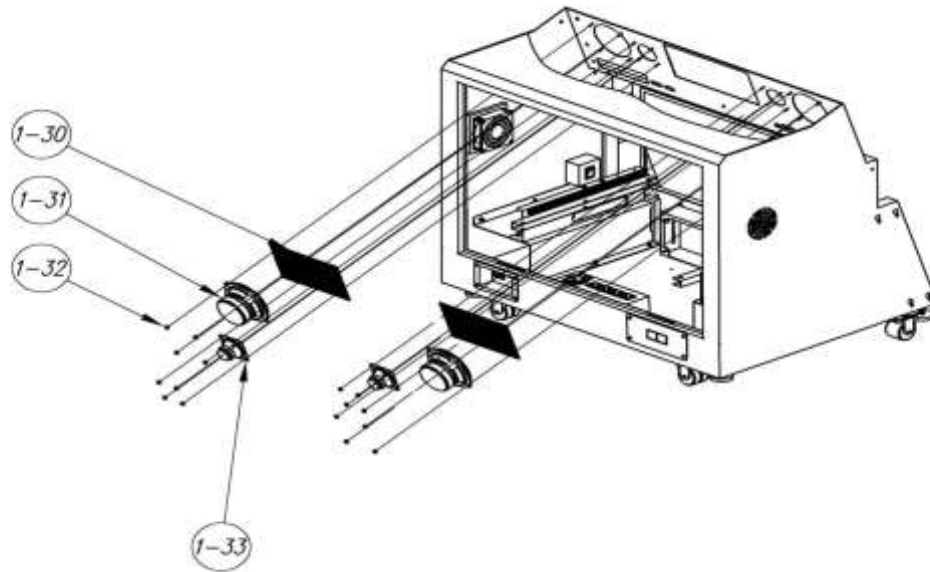

8. Ass'y Body-6

No.	Part No.	Part Name	Description	Q'ty	Remark
1-34	1500061	Cooling Fan		2	
1-35	2200212	Cooling Fan Cover		2	
1-36	6140401	Screw	M 4.0	8	
1-37	2200213	Noise Cover-1		1	
1-38		Power Connector-1		1	
1-39		Power Connector-2		1	
1-40	6140401	Screw	M 4.0	4	
1-41		Screw	M 3.0 FH	2	
1-42		Power Switch-1		1	
1-43	2200214	Noise Cover		1	
1-44	8010403	Nut	M 4.0	2	
1-45		Power Connector-2		1	
1-46	6140401	Screw	M 4.0	4	
1-47	2200215	Service Cover		1	

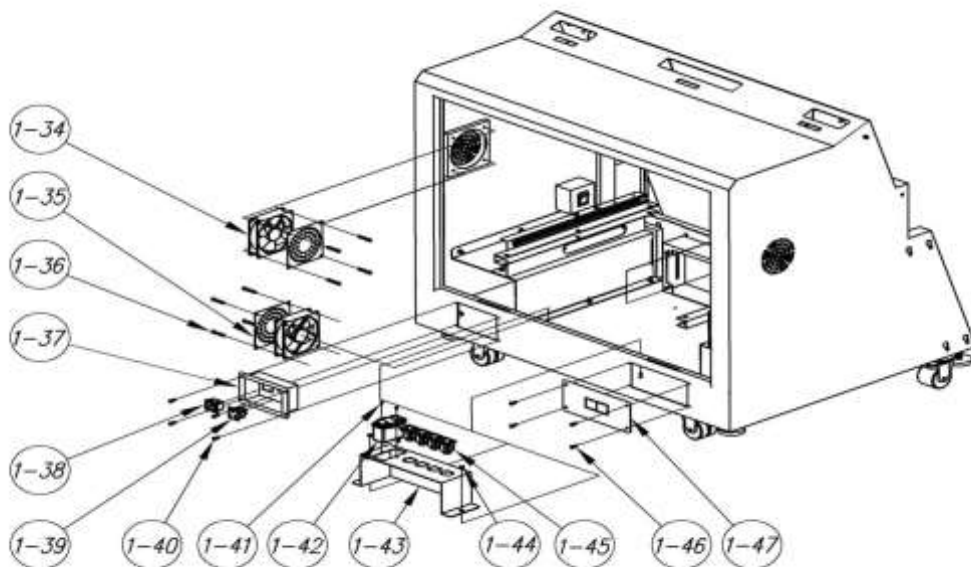

9. Ass'y Body-7

No.	Part No.	Part Name	Description	Q'ty	Remark
1-48		Power Switch-2		1	
1-49	6140401	Screw	M4.0	2	
1-50		Power Switch Case	12t	1	
1-51	2200216	Rail Frame-RH		1	
1-52	8010403	Nut	M4.0	6	
1-53		Ass'y Slider		1	
1-54	6140401	Screw	M4.0	3	
1-55	6140401	Screw	M4.0	3	
1-56	2200217	Wooden Plate Bracket		1	
1-57		Connector-4P		1	
1-58		Connector-8P		1	
1-59		Connector-4P		1	
1-60		Screw	M4.0	2	
1-61	2200218	Rail Frame-LH		1	
1-62		Connector-8P		1	
1-63		Connector-8P		1	
1-64		Connector-8P		1	

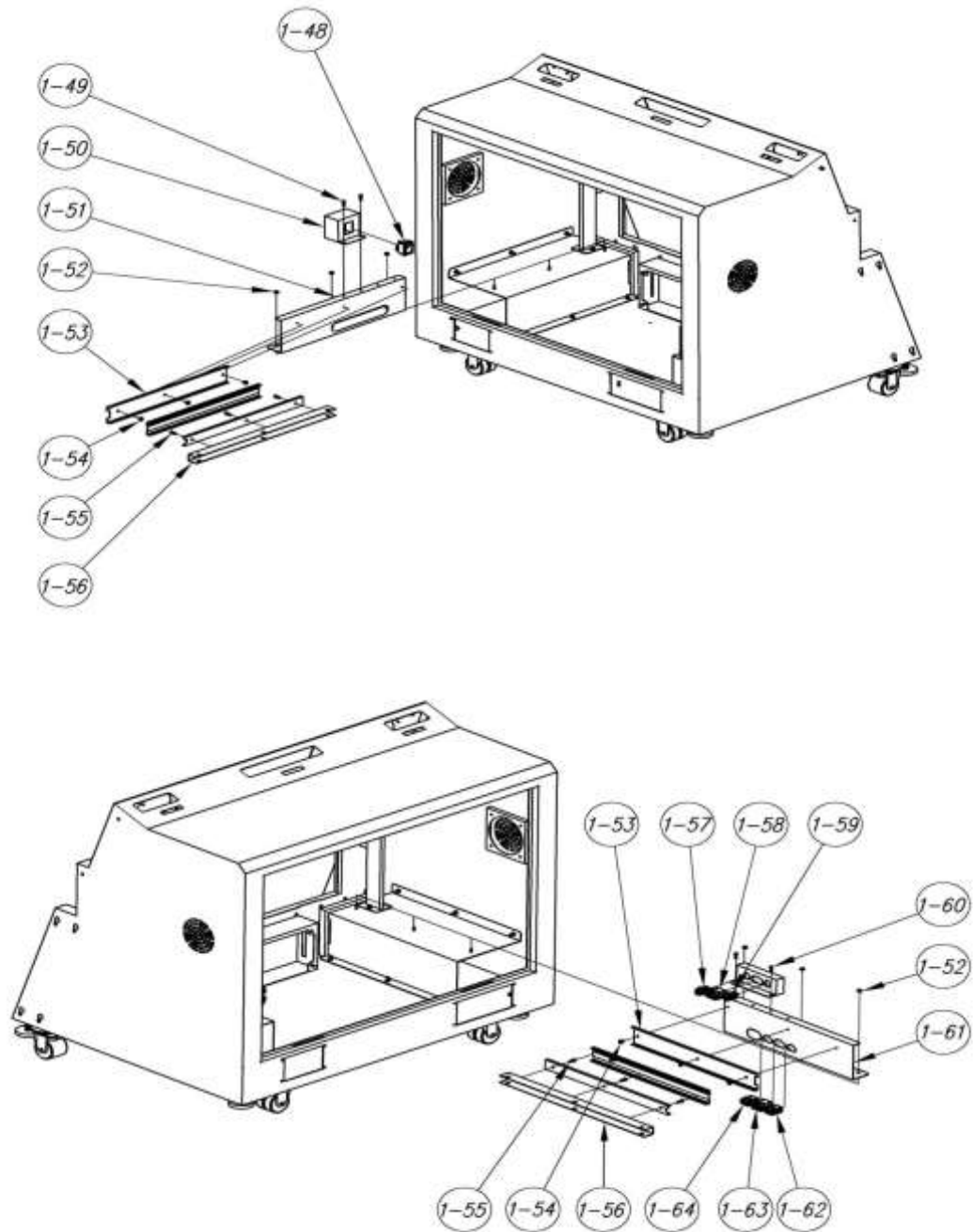

10. Ass'y Body-8

No.	Part No.	Part Name	Description	Q 'ty	Remark
1-65	2200219	Coh Road-LH	12t Back Pant	1	
1-66	8010403	Nut	M4.0 Plate	3	

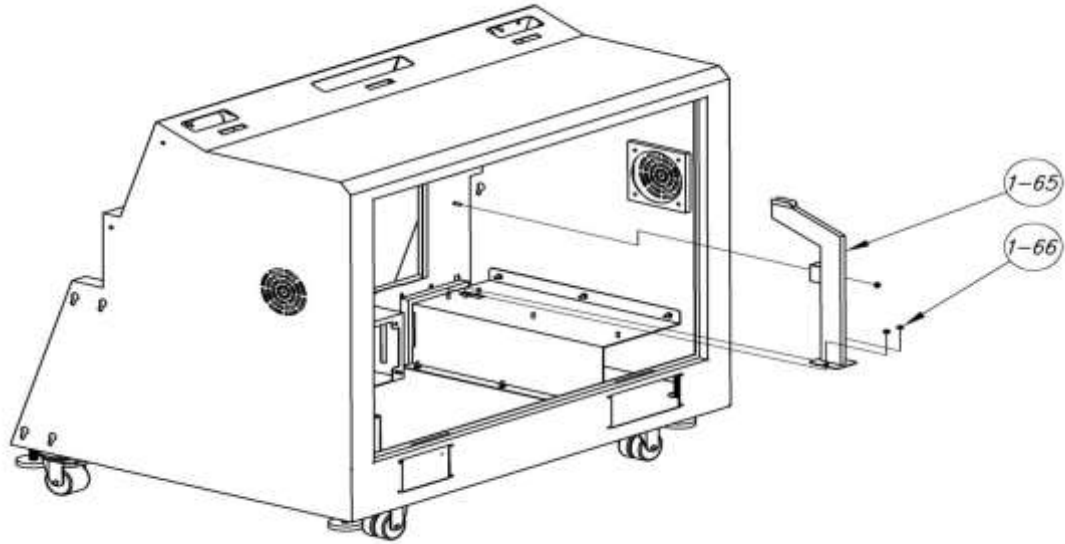

11. Ass'y Body-9

No.	Part No.	Part Name	Description	Q 'ty	Remark
1-67	2200220	Coh Road-RH	12t Back Pant	1	
1-68	8010403	Nut	M4.0 Plate	3	

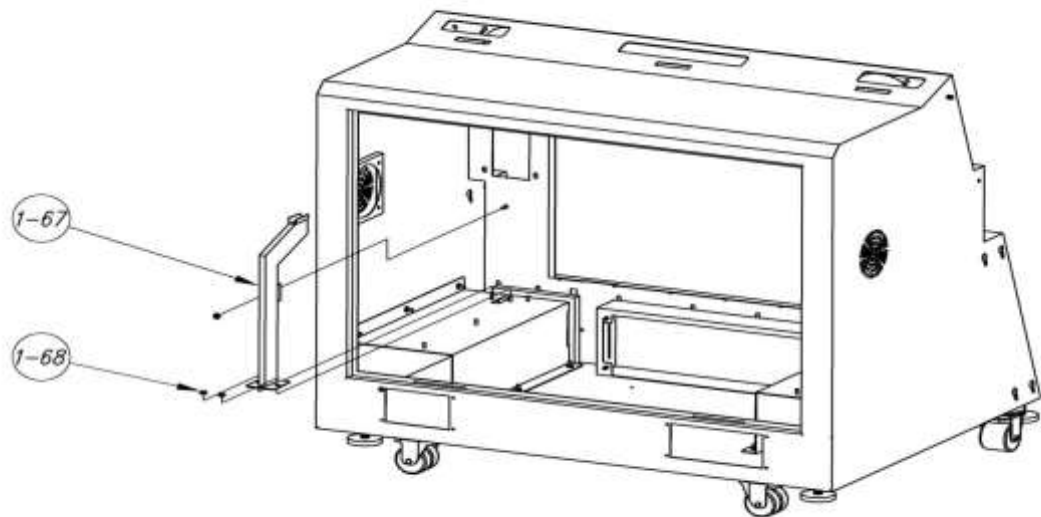

12. Ass'y Body-10

No.	Part No.	Part Name	Description	Q 'ty	Remark
1-69	8010403	Nut	M4.0 Plate	6	
1-70	2200221	Money Case Cover-LH		1	

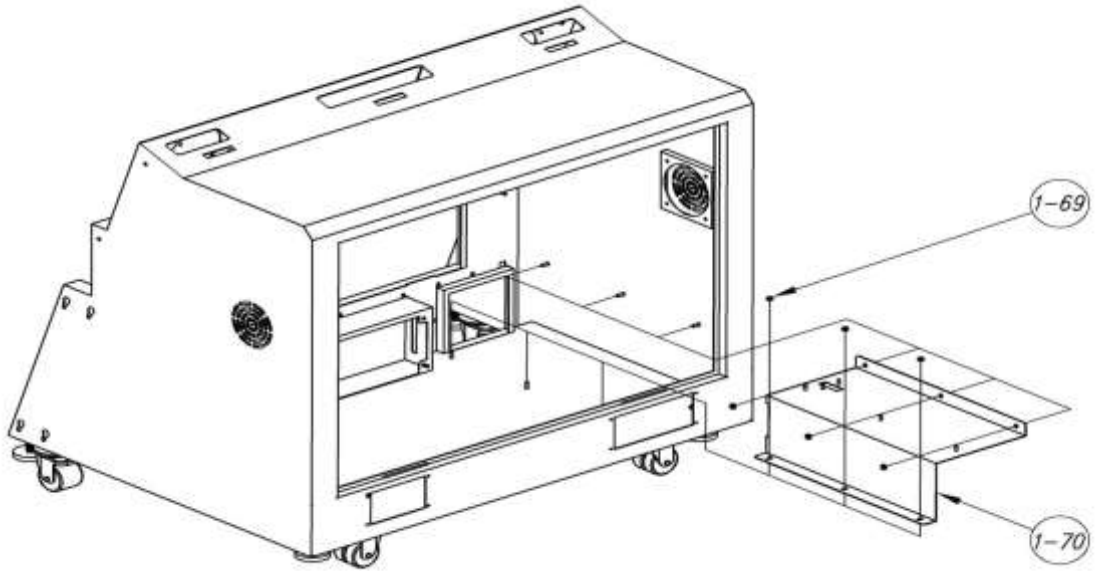

13. Ass'y Body-11

No.	Part No.	Part Name	Description	Q 'ty	Remark
1-71	8010403	Nut	M4.0 Plate	6	
1-72	2200222	Money Case Cover-RH		1	

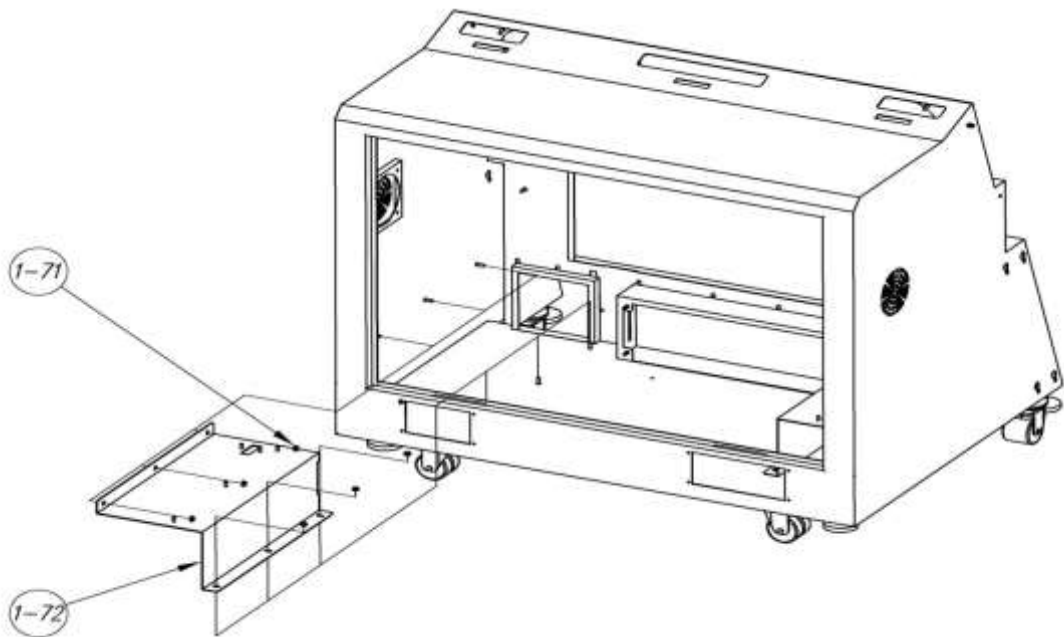

14. Ass'y Body-12

No.	Part No.	Part Name	Description	Q 'ty	Remark
1-73	1700063	Leveling Foot	Black Paint	4	
1-74	1700052	Front Caster	M 16.0 Bolt type	2	
1-75	1700054	Rear Caster	M 8.0 Bolt Type	2	
1-76	8010803	Spring Washer	M 8.0 Type	8	
1-77	8010803	Screw	M 8.0	8	
1-78	2200223	Body Case		1	

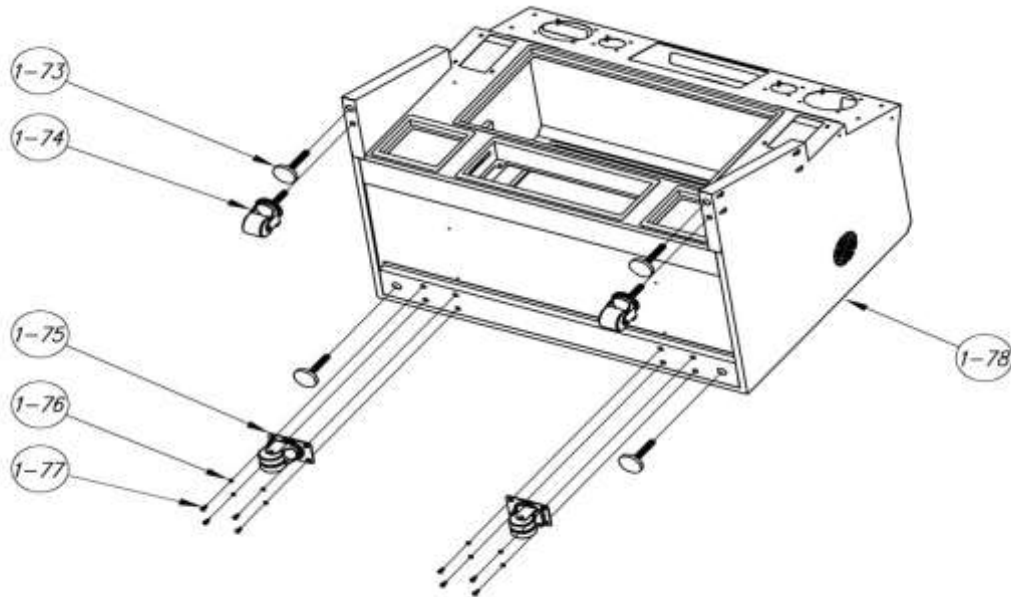

15. Ass'y PR Plate

No.	Part No.	Part Name	Description	Q 'ty	Remark
2-1	4200131	Billboard Acrylic	Acrylic	4	
2-2	8010503	Billboard	P0 2.0t	1	
2-3	8010503	Screw	Special Type M 5.0	1	

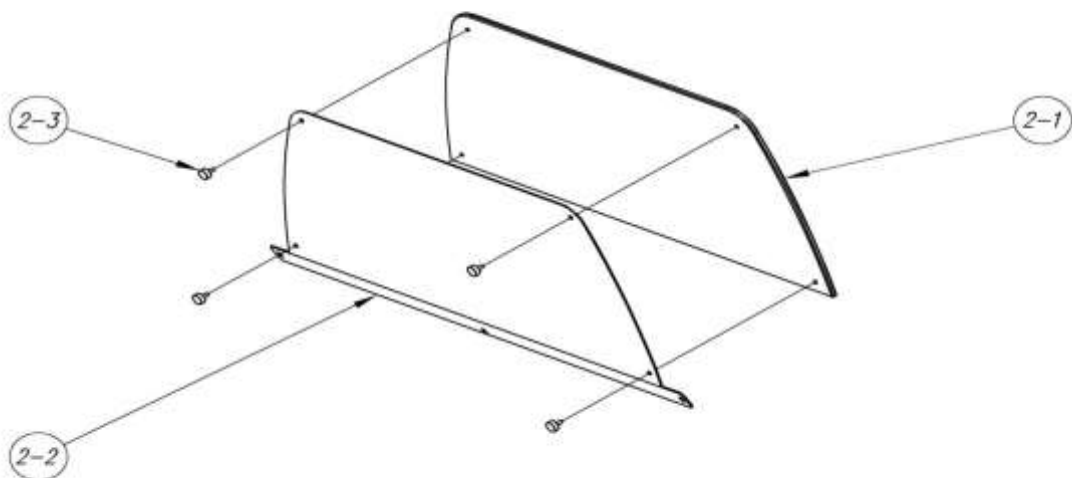

16. Ass'y Speaker Plate

No.	Part No.	Part Name	Description	Q'ty	Remark
3-5	4200133	G lass	Tempered G lass	1	
3-6	2200224	Bracket Plate		1	
3-7	1700021	Ass'y Key		1	
3-8	6140401	Screw	M 4.0	8	
3-9	4600400	Insert Co.h		2	
3-10	2200225	LOGO Plate		2	
3-11	2200226	Upper Plate		1	
3-12	8010303	Screw	M 3.0*8.0L	4	
3-13	8010403	Nut	M 4.0	8	
3-14	2200227	Cover		1	
3-15	6140401	Screw	Special M 4.0	4	
3-16	2200228	Speaker Plate		1	
3-17		Button		5	
3-18	2200229	LED Cover		1	
3-19	8010403	Nut	M 4.0	4	
3-20		Nut-Return Button		2	
3-21		Return Button		2	
3-22		LED Board		2	
3-23	4200132	G lass	Tempered G lass	1	
3-24	6140401	Screw	M 4.0*10.0L	4	
3-25		Acrylic MTG Bracket	SUS	2	

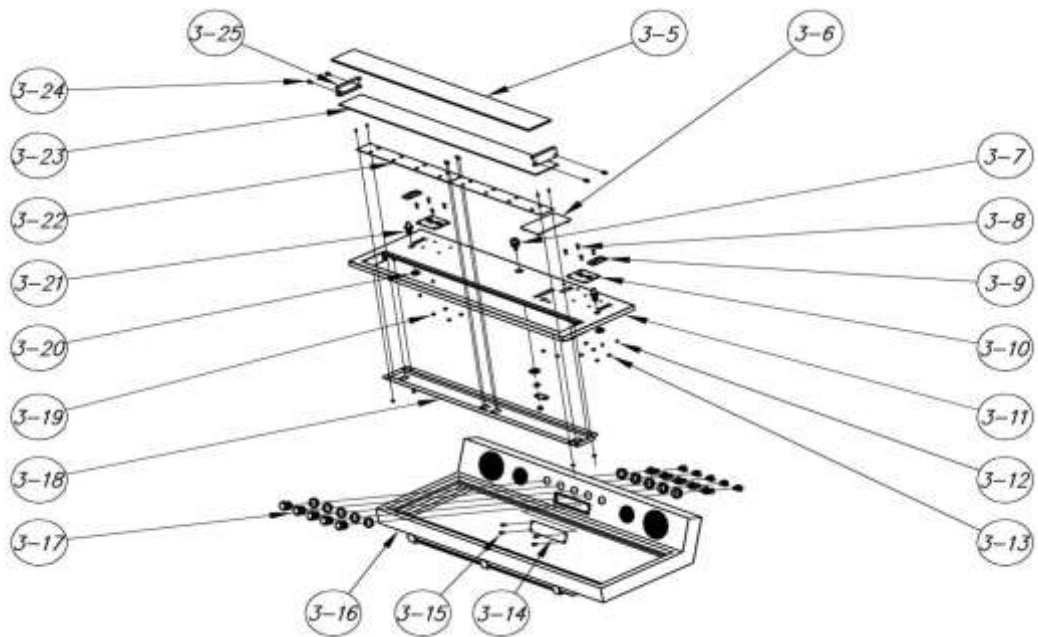

17. Ass'y Button Plate

No.	Part No.	Part Name	Description	Q'ty	Remark
5-1	2200230	Button Plate Upper		1	
5-3	2200231	Button Plate Lower		1	
5-4	1600091	Ass'y Joystick		2	
5-5	2201231	Joystick Lever		2	
5-6		Button-1		10	
5-7		Button-2		2	

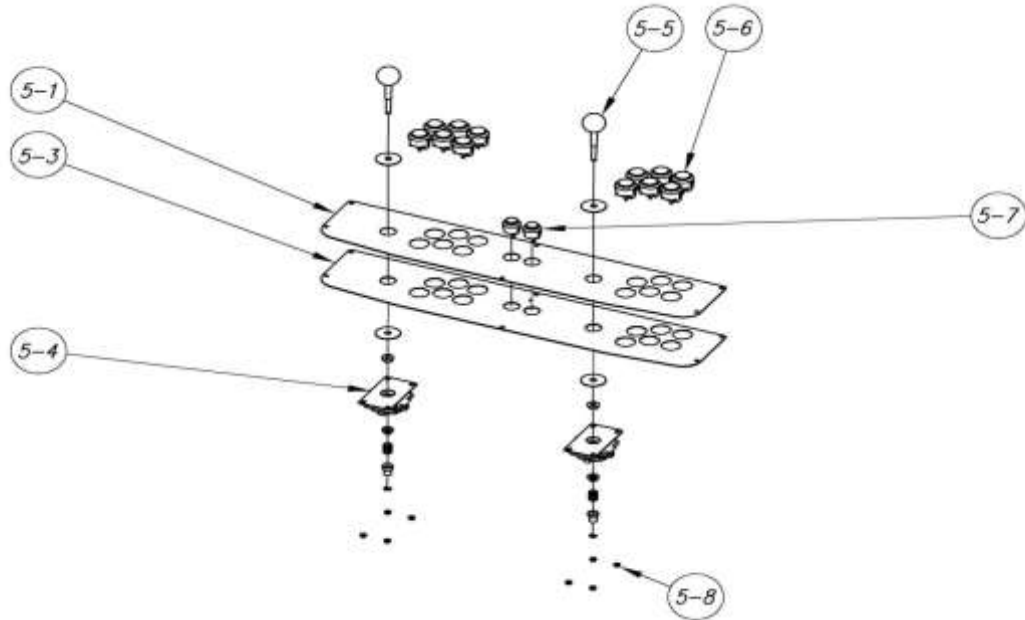

18. Ass'y Button Plate Support

No.	Part No.	Part Name	Description	Q'ty	Remark
6-1	6110301	Screw	M3.0*10.0L	4	
6-2	6140401	Screw	M4.0*10.0L	6	
6-3		Connector-1		1	
6-4		Connector-2		2	
6-5	6110301	Screw	M3.0*10.0L	2	
6-6		dynamic Image Board		1	
6-7	6110301	Screw	M3.0*10.0L	4	
6-8		Sub Board		1	
6-9		ID Board		1	
6-10	6110301	Screw	M3.0*10.0L	4	
6-11	6110301	Screw	M3.0*10.0L	4	
6-12		BOD		2	

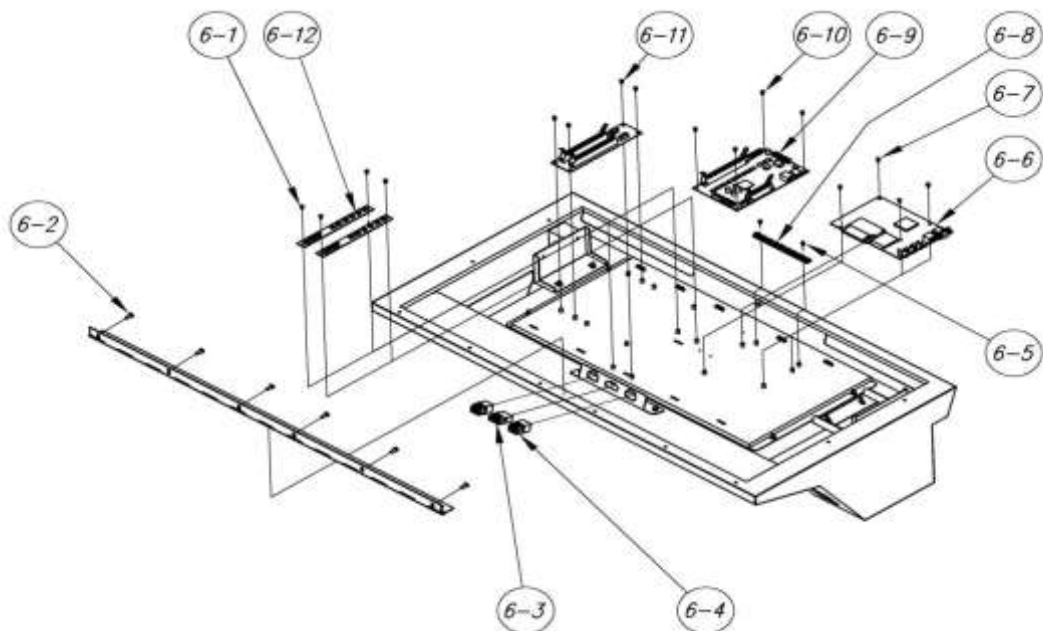

19. Ass'y Upper Frame Cover

No.	Part No.	Part Name	Description	Q'ty	Remark
7-1	6140401	Screw	M 4.0 FH	3	
7-2	2200232	Upper cover		1	
7-3	6140401	Screw	M 4.0 PH	3	
7-4	2200233	Acrylic Plate		1	
7-5	2200234	Screw	M 3.0 RH	8	
7-6		LED Board		2	
7-7	6110301	Acrylic Support Plate		1	

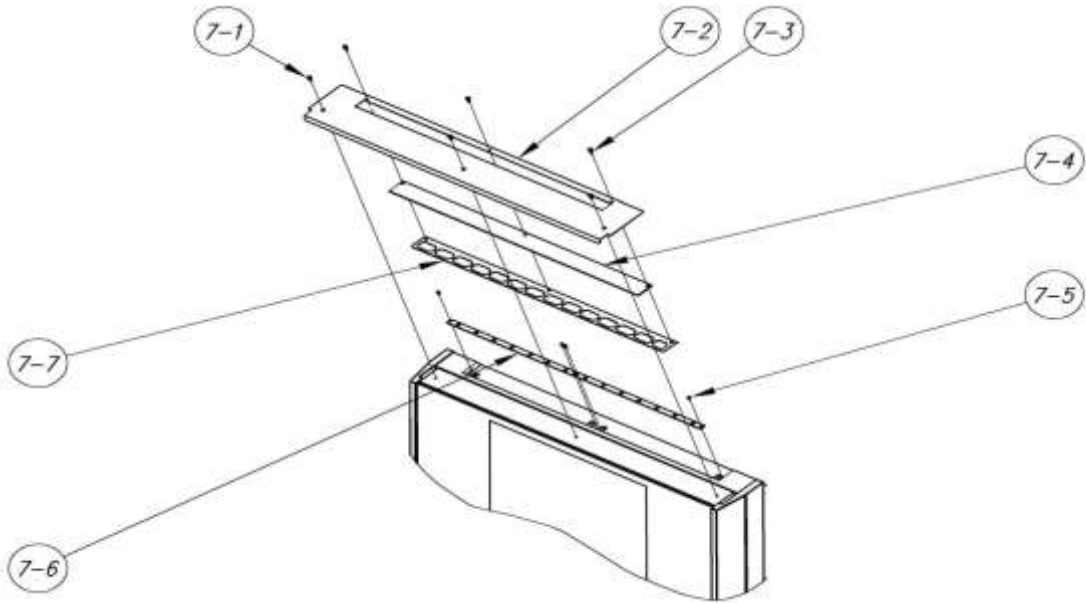

20. Ass'y Power Case

No.	Part No.	Part Name	Description	Q'ty	Remark
8-1	2200235	Upper Power Case		1	
8-2	6110301	Screw	M3.0 RH	4	
8-3	6110301	Screw	M3.0 RH	4	
8-4		AMP Board		1	
8-5		Sub Board		1	
8-6	6110301	Screw	M3.0 RH	2	
8-8		Sw itch		1	
8-9	1500111	Counter		4	
8-10	1500221	Push Sw itch		3	
8-11	1500121	Power Sw itch		1	
8-12		VoLume Knob		2	
8-13	6110301	Screw	M3.0 RH	4	
8-14	6110301	Screw	M3.0 RH	4	
8-15		Power Supply		1	
8-16	2200236	Power Case		1	
8-17	6110501	Screw	ØD	4	
8-18	1500061	Cooling Fan		1	
8-19	2200237	Cooling Fan Cover		1	
8-20	6110501	Screw	ØD	4	
8-21	1500121	Power Sw itch		1	
8-22		Connector-2		2	
8-23		Connector-3		1	
8-24		Connector-4		1	
8-25		Connector-5		1	
8-26	6110301	Screw	M3.0 RH	4	
8-27		ID Board		1	

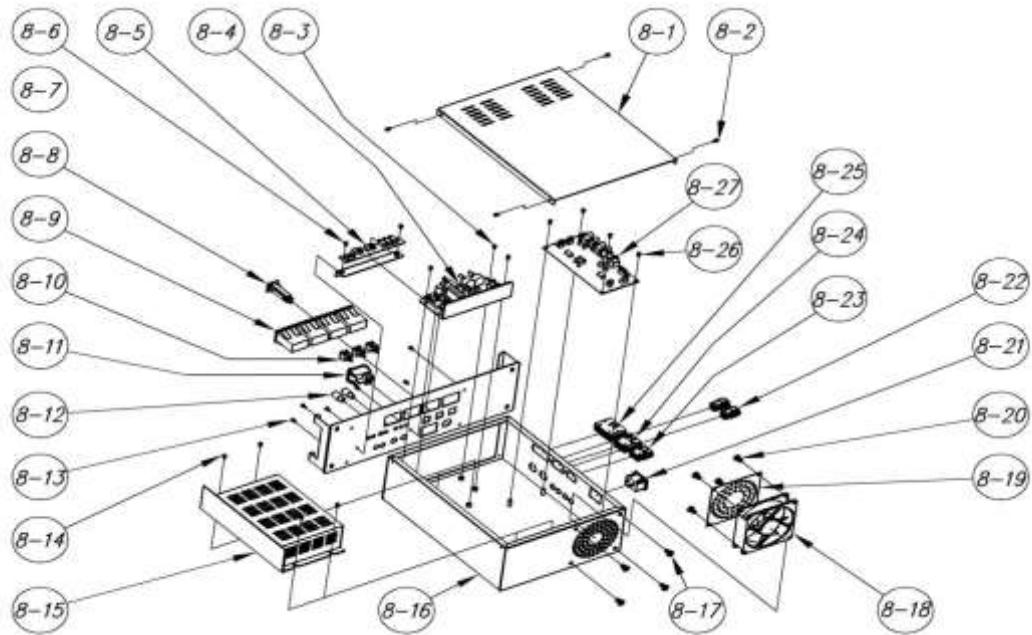

21. Ass'y 20.1" LCD

No.	Part No.	Part Name	Description	Q'ty	Remark
9-1	1500011	LCD	20.1"	1	
9-2	2200238	Open Frame	20.1"	1	
9-3	2200239	Monitor M TG Angle Bracket		2	
9-4		Board		1	
9-5	6110301	Screw	M 3.0 RH	4	
9-6	2200240	Open Frame Cover		1	
9-7	6110301	Screw	M 3.0 RH	4	
9-8		Inverter Board		1	
9-9	6110301	Screw	M 3.0 RH	3	

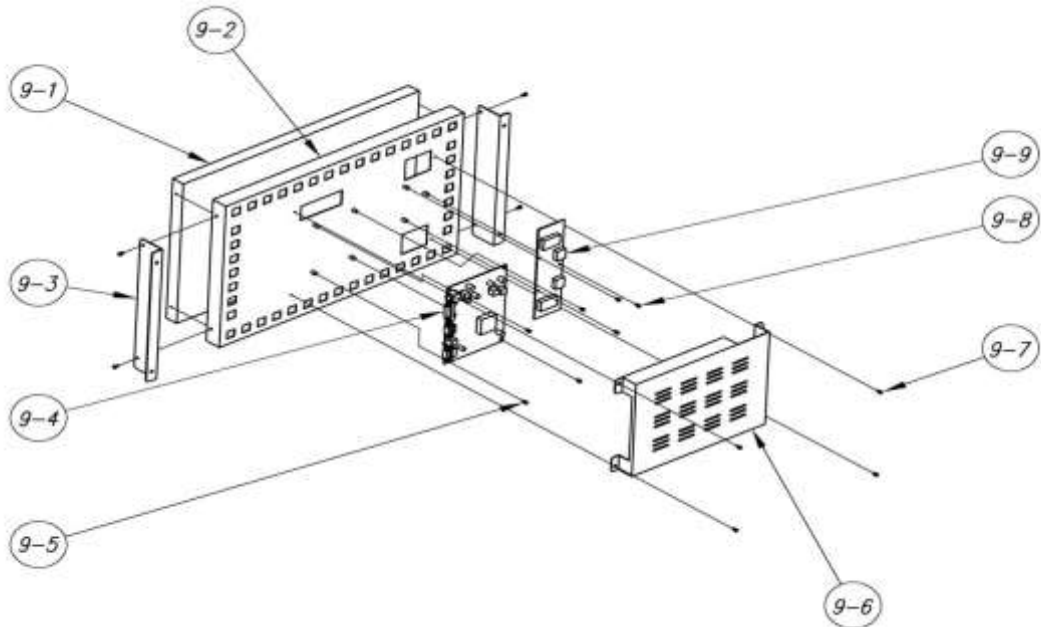

22. Ass'y 32" LCD

No.	Part No.	Part Name	Description	Q'ty	Remark
10-1	1500021	LCD	32"	1	
10-2	2200241	Monitor M TG Angle Bracket	32"	2	
10-3	6110401	Screw	M 4.0 RH	6	
10-4	6110301	Screw	M 3.0 RH	4	
10-5	2200242	Open Frame cover	32"	1	
10-6	6110301	Screw	M 3.0 RH	4	
10-7		Board		1	
10-8	2200243	Open Frame		1	
10-9	6110301	Screw	M 3.0 RH	4	

